

MarCal 16 EWR / 16 ER. Digital Caliper

Functions 16 EWR:

- ON/OFF
- AUTO-ON / OFF
- RESET (set display to zero)
- PRESET (for entering a numerical value)
- Reversal of counting direction
- mm/inch
- LOCK function (key lock)



Functions 16 ER:

- ON/OFF
- AUTO-ON / OFF
- RESET (set display to zero)
- mm/inch
- LOCK function (key lock)

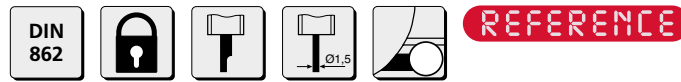

- High contrast analog display
- Locking screw above
- Lapped guide way
- Measuring blade for inside measurements
- Slide and beam made of hardened stainless steel
- Step measuring function
- Immediate measurements due to the Reference system
- Raised guide ways for the protection of the scale
- Excellent resistance against dust, coolants and lubricants
- Dirt wipers are integrated in the slide

Features 16 EWR:

- **Digit height:** 11 mm
- **Energy supply:** Battery, life span ca. 3 years
- **IP protection category:** IP 67
- **Scope of delivery:** Battery, Instruction manual, Case

Features 16 ER:

- **Digit height:** 11 mm
- **Energy supply:** Battery, life span ca. 3 years
- **Scope of delivery:** Battery, Instruction manual, Case

Technical Data

Order no.	Product type	Measuring range	Resolution	Error limit	Standard	Depth Rod	Friction wheel
		mm	mm/inch	mm			
4103304	16 EWR	0–200	0,01 / .0005"	0,03	DIN 862	rectangular	
4103305	16 EWR	0–200	0,01 / .0005"	0,03	DIN 862	rectangular	•
4103306	16 EWR	0–300	0,01 / .0005"	0,04	Factory standard		
4103307	16 EWR	0–300	0,01 / .0005"	0,04	Factory standard		•
4103205	16 ER	0–200	0,01 / .0005"	0,03	DIN 862	rectangular	
4103206	16 ER	0–200	0,01 / .0005"	0,03	DIN 862	rectangular	•
4103207	16 ER	0–300	0,01 / .0005"	0,04	Factory standard		
4103208	16 ER	0–300	0,01 / .0005"	0,04	Factory standard		•

Order no.	a	b	c	d	e
	mm	mm	mm	mm	mm
4103304	10	50	19	285	16
4103305	10	50	19	285	16
4103306	14	64	19	388	16
4103307	14	64	19	388	16
4103205	10	50	19	285	16
4103206	10	50	19	285	16
4103207	14	64	19	388	16
4103208	14	64	19	388	16

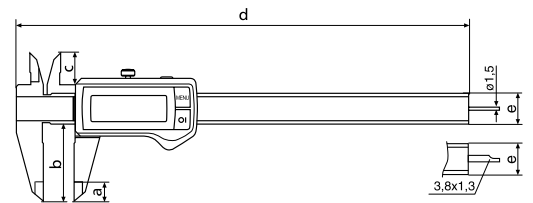

Accessories

Order no.	For measuring instrument	Product name	Product type
4102020	16 ER, 16 ER, 16 ER, 16 ER, 16 EWR, 16 EWR, 16 EWR, 16 EWR	Depth bridge (75 x 7 mm)	16 Em
4102520	16 ER, 16 ER, 16 ER, 16 ER, 16 EWR, 16 EWR, 16 EWR, 16 EWR	Battery 3 V, CR 2032	

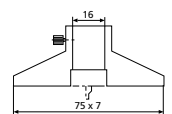

16 Em